

Bat-series Delta Robot

Bat600M-S3

It features high speed and agility, high positioning accuracy, and strong power, facilitating high-speed and high-precision flexible production.

Applicable industries
Sorting, handling, loading and unloading, boxing, gluing, and other links in electronics, food, medicine, daily chemicals, logistics, and new energy.

Product features

Load	3kg
Working space diameter	600mm
Repeat positioning accuracy	±0.05mm
Configuration	4th axis under-mounted



Specification

Bat600M-S3		
Rated load		
3kg		
Max. load		
6kg		
Working space diameter		
600mm		
Number of axes		
4		
Repeat positioning accuracy		
±0.05mm		
Angular repeat positioning accuracy		
±0.05°		
25/305/25	0.1kg	0.27s
	1kg	0.29s
	3kg	0.35s
90/400/90	0.1kg	0.35s
	1kg	0.37s
	3kg	0.42s
Power supply voltage		
Three-phase AC 380 V±10%, 50/60 Hz		
Rated power		
3.3KW		
Ambient temperature		
0-45°C		
Relative humidity		
5-95%		
Degree of protection		
IP54		
Safety		
Equipped with monitoring, emergency stop, and installation functions		
Radiation		
EMC shielding		
Installation method		
Suspended type		
Weight of the robot body		
69kg		
I/O interface		
4-channel configurable digital I/O 8-channel universal digital I/O (8 additional I/O channels can be added) 2-channel encoder input		
Ethernet		
2		
USB		
2		
RS232\RS485		
1		
EtherCAT		
1		
Communication protocol		
Modbus-RTU/TCP、Socket		

*: For specific requirements regarding line selection, interface configuration, and other optional needs, please consult the technicians of RobotPhoenix.

Working range

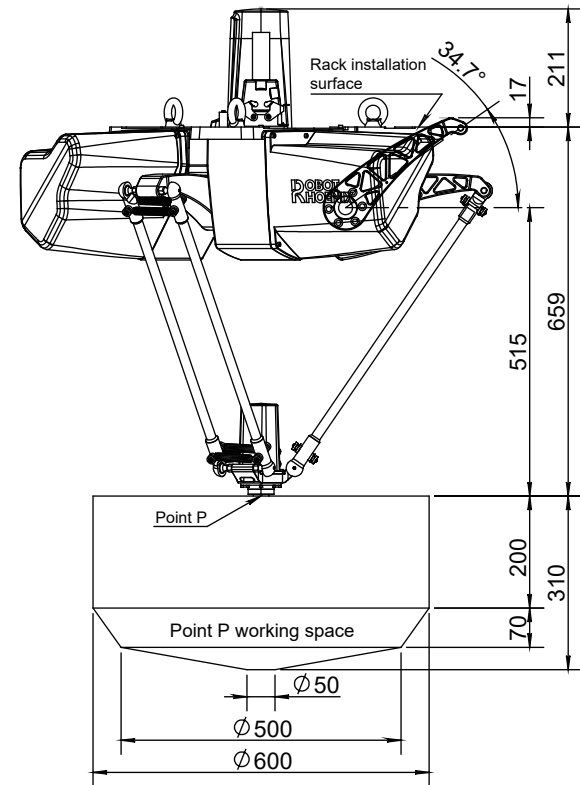

Model	Bat600M-S3
Distance from installation surface to top of equipment	211mm
Max. upper arm elevation and horizontal plane angle	34.7°
Max. elevation of the upper arm to the height of the installation surface	17mm
Distance from installation surface to upper plane of working space	659mm
Distance from the reducer shaft center to the upper plane of the working space	515mm
Total height of the upper and lower limits of the working space	310mm
Height of the cylindrical part of the working space	200mm
Height of the conical frustum part of the working space	70mm
Transition diameter of the conical column in the working space	500mm
Bottom diameter of the conical column in the working space	50mm
Diameter of the circular table part of the working space	600mm
Min. installation size of the robot body	1000mm

Installation size

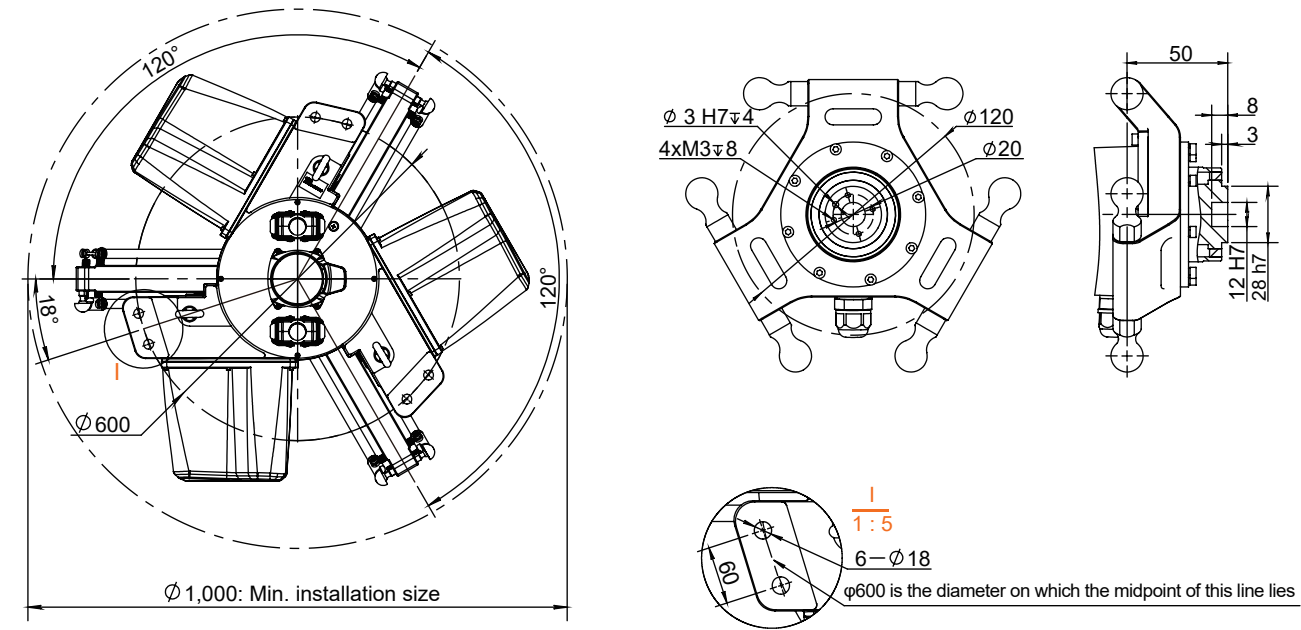

*: Any changes resulting from upgrading our products will not be notified separately.