

Python-series SCARA Robot

Python450-B6

With superior speed, accuracy, linearity, and verticality performance, it can quickly and precisely complete tasks such as gluing, assembly, transfer, and packaging.

Applicable industries

Transportation and loading/unloading, dispensing, gluing, assembly and inspection processes in electronics, food, medicine, daily chemicals, and semiconductors.

Product features

Rated load	3kg
Max. load	6kg
Number of axes	4
Installation type	Table-mounted



Specification

Python450-B6

Robotic arm length	Robotic arms 1 & 2	450mm
	Robotic arm 1	200mm
	Robotic arm 2	250mm
Max. operating speed	Joints 1 & 2	6600mm/s
	Joint 3	1100mm/s
	Joint 4	2360°/s
Repetitive positioning accuracy	Joints 1 & 2	±0.02mm
	Joint 3	±0.01mm
	Joint 4	±0.01°
Joint 4 allowable inertial torque	Rated	0.01kg·m <sup>2</sup>
	Max.	0.12kg·m <sup>2</sup>
Working range	Joint 1	±132°
	Joint 2	±150°
	Joint 3	240mm
	Joint 4	±360°
25/305/25	0.1kg	0.38s
	1kg	0.38s
	3kg	0.39s
Power supply voltage		Single-phase AC 220 V-240 V, 50/60 Hz
Rated power		1.3KW
Ambient temperature		0-45°C
Relative humidity		5-95%
Degree of protection		IP54
Installation aperture		172x140mm; 4-φ12
Electrical interface		15-channel custom I/O
Airway		φ6*2+φ4*2
Weight		24 kg (excluding cables)
I/O interface		4-channel configurable digital I/O 8-channel universal digital I/O (8 additional I/O channels can be added) 2-channel encoder input
Ethernet		2
USB		2
RS232\RS485		1
EtherCAT		1
Communication protocol		Modbus-RTU/TCP、Socket

\*: For specific requirements regarding line selection, interface configuration, and other optional needs, please consult the technicians of Robotphoenix.



Working range (unit: mm)

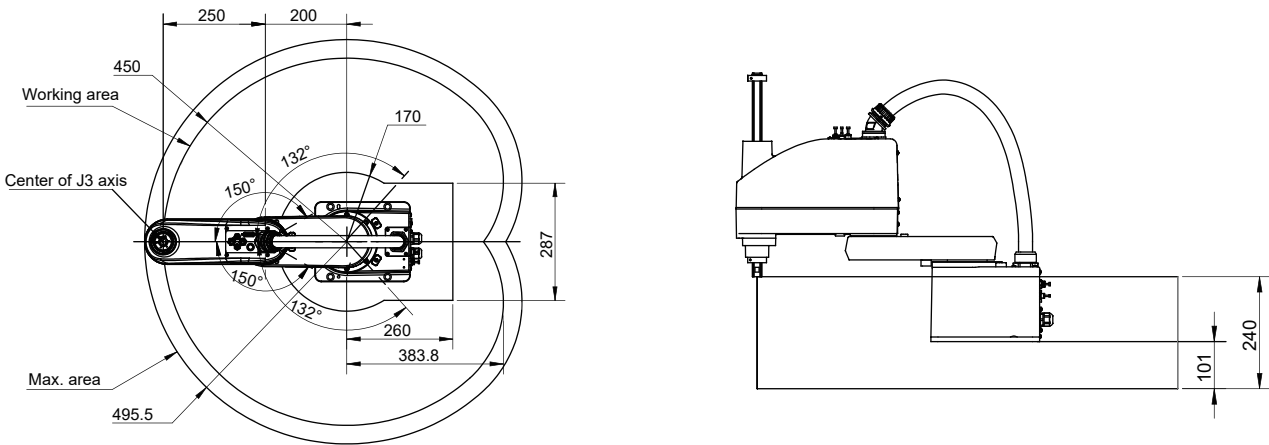

Installation size (unit: mm)

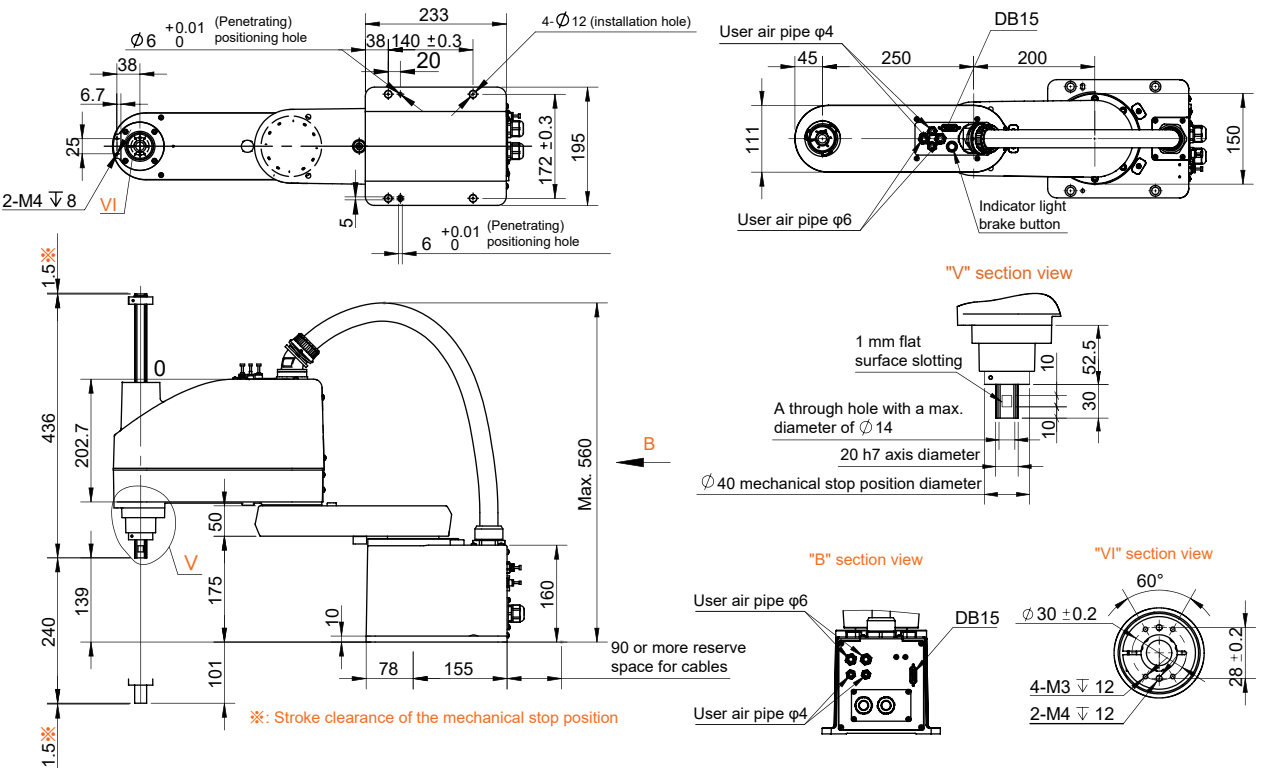

Load - Frequency

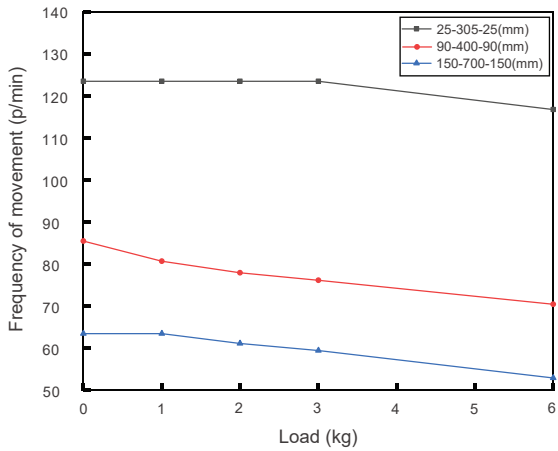

Moving trajectory					
Cyclic mode	P1 → P2 → P3 → P4 → P3 → P2 → P1				
h (mm )	25	90	100	150	200
b (mm )	305	400	500	700	900

\*: Any changes resulting from upgrading our products will not be notified separately.