

Bat-series Delta Robot

Bat2000M-S15

It features high speed and agility, high positioning accuracy, and strong power, facilitating high-speed and high-precision flexible production.

Applicable industries

Sorting, handling, loading and unloading, boxing, gluing, and other links in electronics, food, medicine, daily chemicals, logistics, and new energy.

Product features

Rated load	15kg
Working space diameter	2000mm
Repeat positioning accuracy	±0.1mm
Configuration	4th axis under-mounted

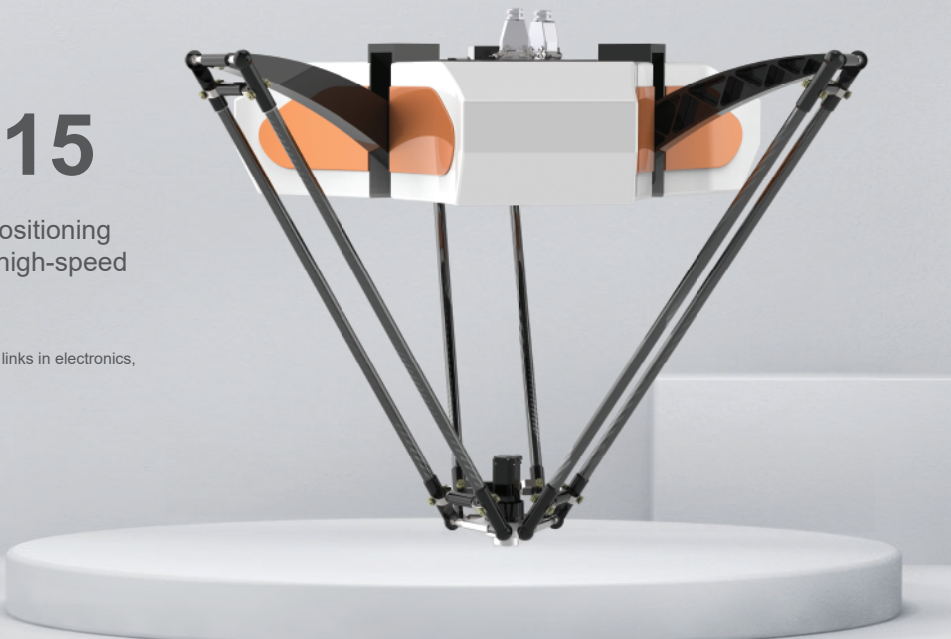

Specification

Bat2000M-S15

Rated load			15kg
Working space diameter			2000mm
Number of axes			4
Repeat positioning accuracy			±0.1mm
Angular repeat positioning accuracy			±0.05°
25/305/25	0.1kg		0.39s
	1kg		\
	3kg		\
	6kg		0.47s
90/400/90	0.1kg		0.56s
	1kg		\
	6kg		0.6s
	15kg		0.7s
Power supply voltage			Three-phase AC 380 V±10%, 50/60 Hz
Rated power			6.1KW
Ambient temperature			0-45°C
Relative humidity			5-95%
Degree of protection			IP54
Safety			Equipped with monitoring, emergency stop, and installation functions
Radiation			EMC shielding
Installation method			Hoisting
Weight of the robot body			220kg
I/O interface			4-channel configurable digital I/O 8-channel universal digital I/O (8 additional I/O channels can be added) 2-channel encoder input
Ethernet			2
USB			2
RS232\RS485			1
EtherCAT			1
Communication protocol			Modbus-RTU/TCP、Socket
Certification			CE

\*: For specific requirements regarding line selection, interface configuration, and other optional needs, please consult the technicians of RobotPhoenix.

Working range

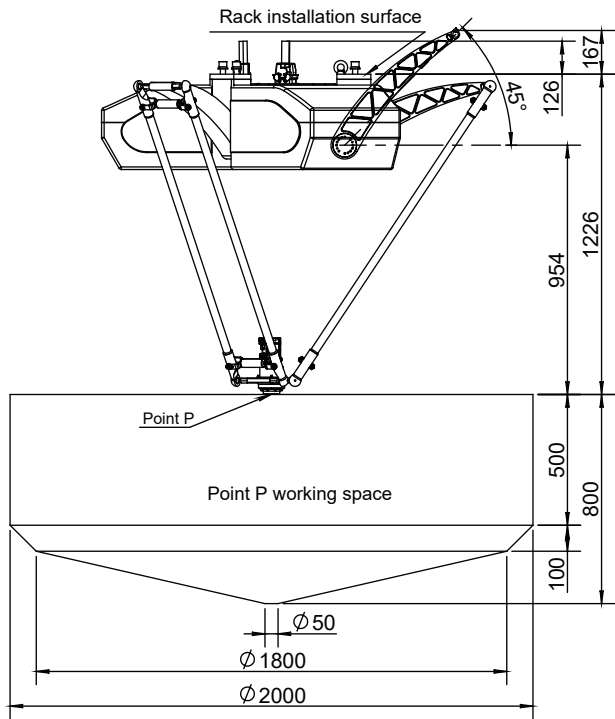

Model

Bat2000M-S15

Distance from installation surface to top of equipment	126mm
Max. upper arm elevation and horizontal plane angle	45°
Max. elevation of the upper arm to the height of the installation surface	167mm
Distance from installation surface to upper plane of working space	1226mm
Distance from the reducer shaft center to the upper plane of the working space	954mm
Total height of the upper and lower limits of the working space	800mm
Height of the cylindrical part of the working space	500mm
Height of the conical frustum part of the working space	100mm
Transition diameter of the conical column in the working space	1800mm
Bottom diameter of the conical column in the working space	50mm
Diameter of the circular table part of the working space	2000mm
Min. installation size of the robot body	2350mm

Installation size

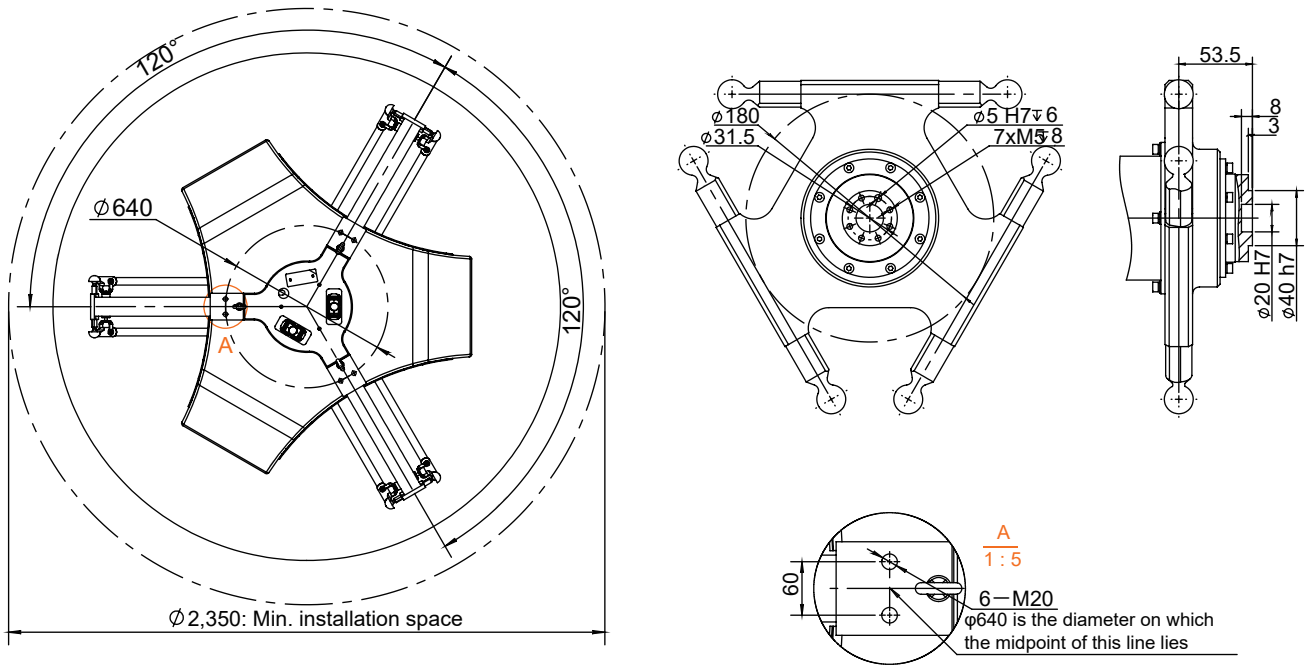

\*: Any changes resulting from upgrading our products will not be notified separately.