

Bat-series Delta Robot

Bat800-S3

It features high speed and agility, high positioning accuracy, and strong power, facilitating high-speed and high-precision flexible production.

Applicable industries
Sorting, handling, loading and unloading, boxing, gluing, and other links in electronics, food, medicine, daily chemicals, logistics, and new energy.

Product features

Load	3kg
Working space diameter	800mm
Repeat positioning accuracy	±0.05mm
Configuration	Standard 4-axis



Specification

Specification			Bat800-S3
Rated load			3kg
Max. load			12kg
Working space diameter			800mm
Number of axes			4
Repeat positioning accuracy			±0.05mm
4-axis repeat positioning accuracy			±0.1°
25/305/25	0.1kg		0.25s
	1kg		0.27s
	3kg		0.33s
90/400/90	0.1kg		0.34s
	1kg		0.37s
	3kg		0.4s
Power supply voltage			Three-phase AC 380 V±10%, 50/60 Hz
Rated power			3.4KW
Ambient temperature			0-45°C
Relative humidity			5-95%
Degree of protection			IP54
Safety			Equipped with monitoring, emergency stop, and installation functions
Radiation			EMC shielding
Installation method			Suspended type
Weight of the robot body			70kg
I/O interface			4-channel configurable digital I/O 8-channel universal digital I/O (8 additional I/O channels can be added) 2-channel encoder input
Ethernet			2
USB			2
RS232\RS485			1
EtherCAT			1
Communication protocol			Modbus-RTU/TCP、Socket
Certification			 MTBF

*: For specific requirements regarding line selection, interface configuration, and other optional needs, please consult the technicians of RobotPhoenix.

Working range

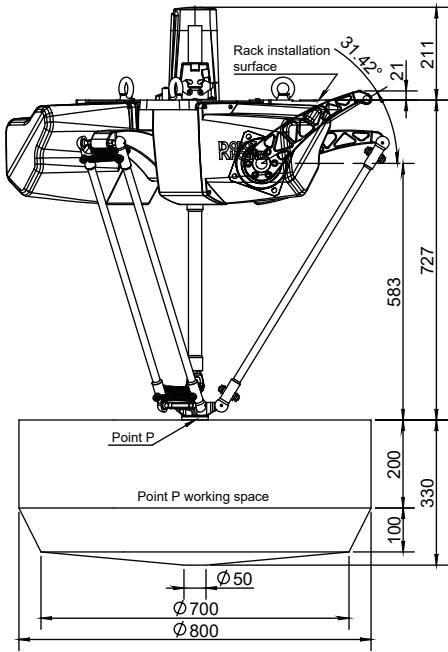

Model	Bat800-S3
Distance from installation surface to top of equipment	211mm
Max. upper arm elevation and horizontal plane angle	31.42°
Max. elevation of the upper arm to the height of the installation surface	21mm
Distance from installation surface to upper plane of working space	727mm
Distance from the reducer shaft center to the upper plane of the working space	583mm
Total height of the upper and lower limits of the working space	330mm
Height of the cylindrical part of the working space	200mm
Height of the conical frustum part of the working space	100mm
Transition diameter of the conical column in the working space	700mm
Bottom diameter of the conical column in the working space	50mm
Diameter of the circular table part of the working space	800mm
Min. installation size of the robot body	1000mm

Installation size (unit: mm)

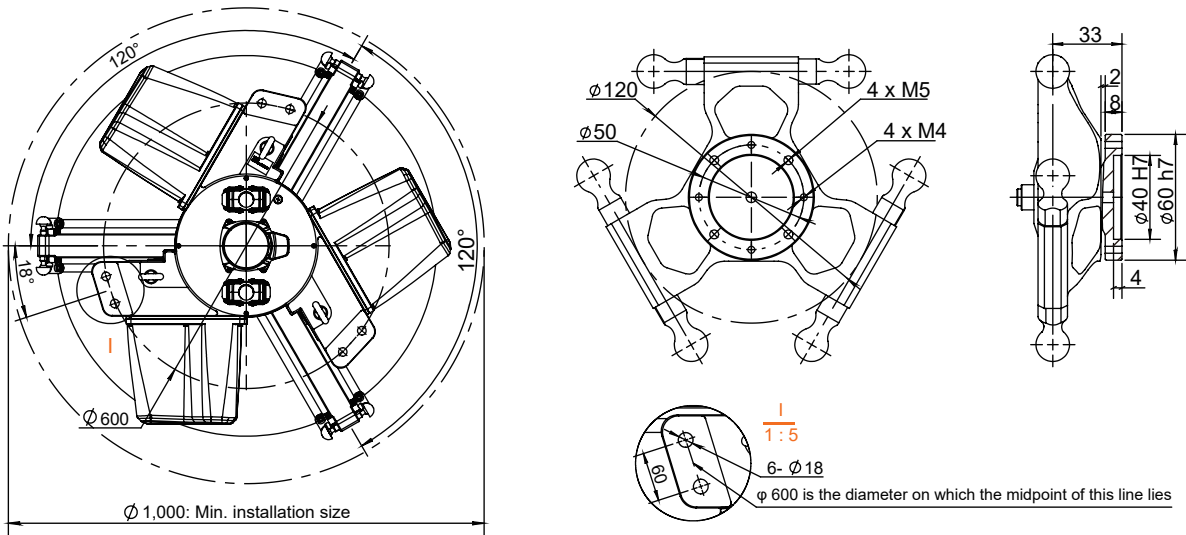

Load - Frequency

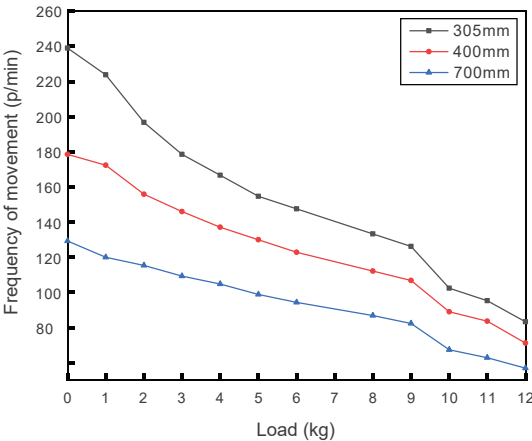

Moving trajectory							
Cyclic mode	P1 → P2 → P3 → P4 → P3 → P2 → P1						
h (mm)	25	90	125	150	200	250	300
b (mm)	305	400	550	700	900	1200	1500

*: Any changes resulting from upgrading our products will not be notified separately.